

Killybegs Regeneration Strategy + Action Plan

The Killybegs Regeneration Strategy and Action Plan was commissioned by the Killybegs Regeneration Group in conjunction with Donegal County Council. The project is funded by BIMFLAG and match funded by Donegal County Council. The study was led by Architects Pasparakis Friel.

Killybegs already has many of the critical ingredients which make it a great place to live in and an exciting and memorable place to visit. Through an intensive consultation and research and analysis based process the consultant team identified opportunities and unlocked the critical issues to create a 2040 vision to make Killybegs one of Ireland's most unique and vibrant coastal towns.

The proposed rethinking of Killybegs' public realm holds the ability to better connect the town and its people with its key asset; the Atlantic Ocean. The plan prioritises retrofitting of existing buildings before building anew. These new uses within existing structures form a necklace of activities for the community and visitors as they traverse Killybegs' proposed new waterfront boardwalk. A new linear river park intersects with the boardwalk; drawing people between the historic town centre and the waterfront.



Town Centre Urban Realm

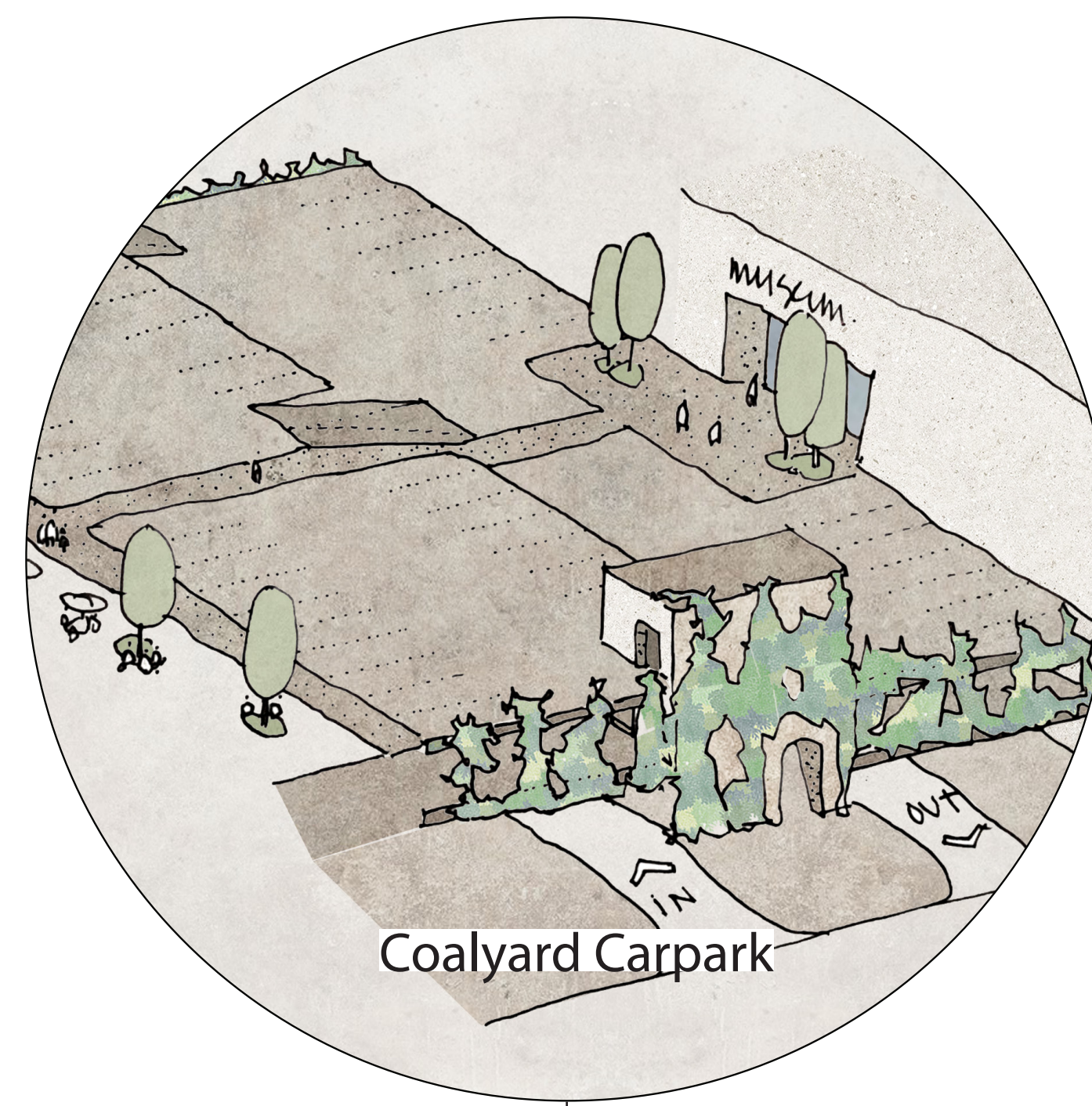

Coalyard Carpark

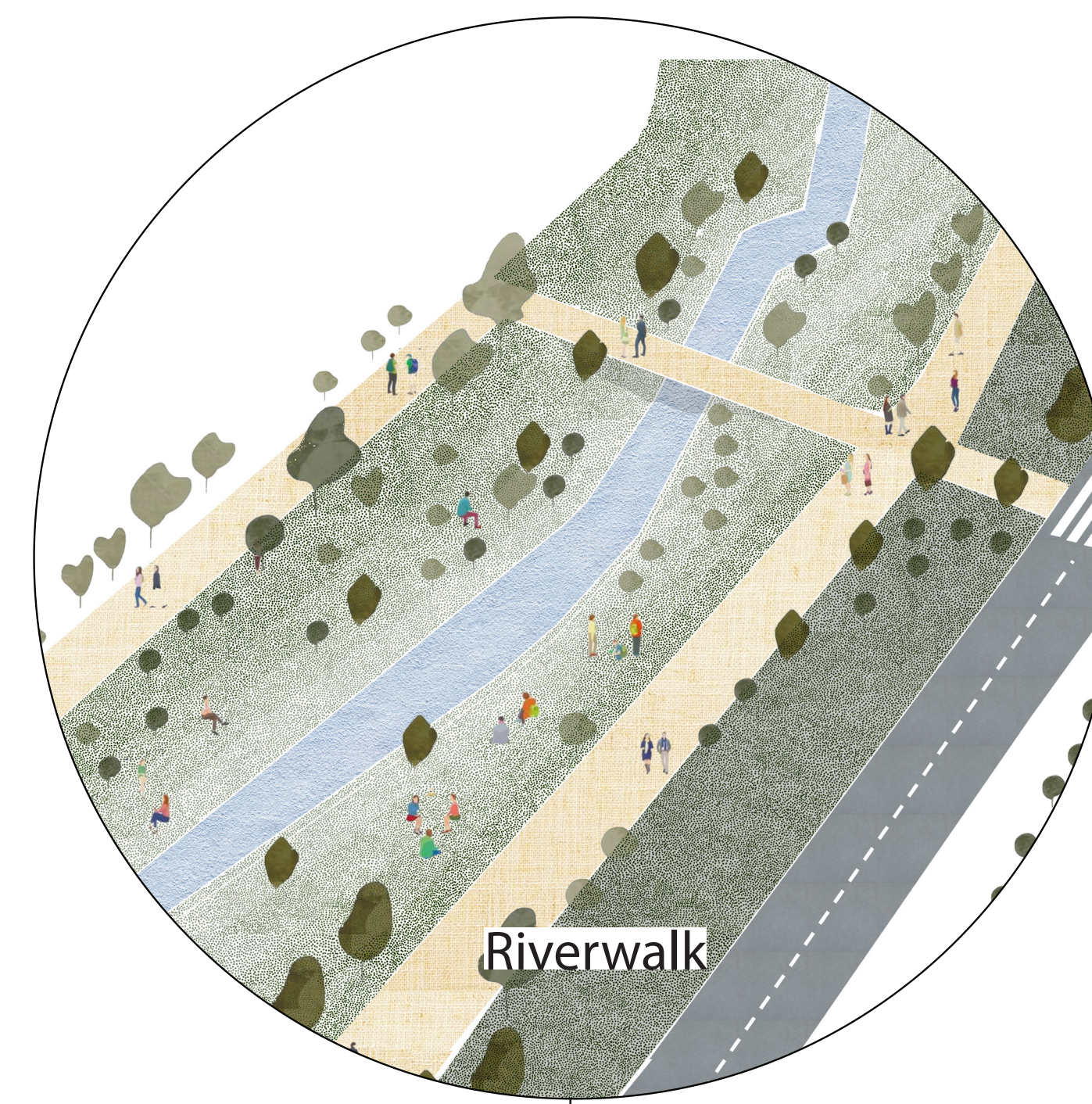

Riverwalk

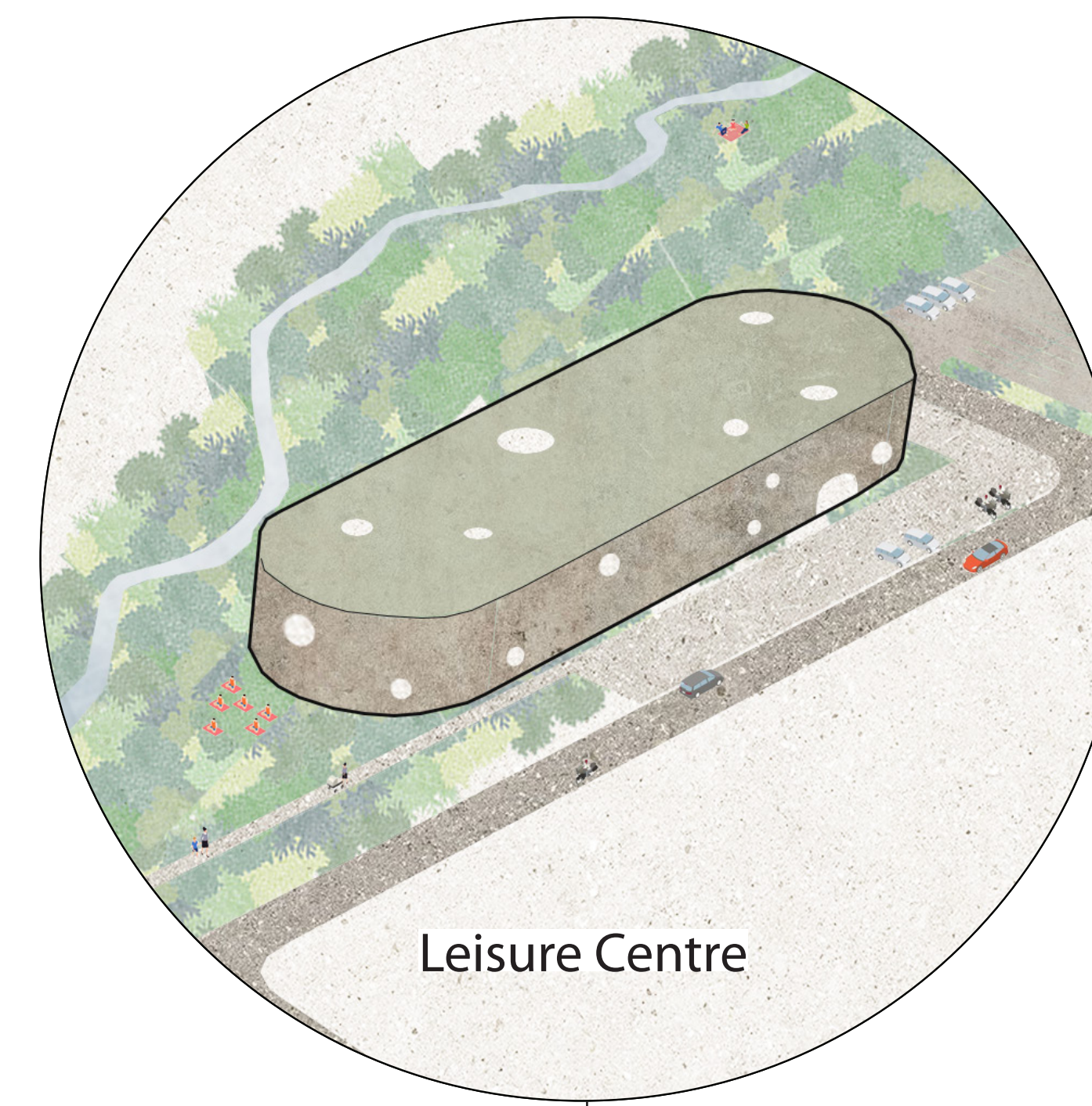

Leisure Centre



Northern Arrival

Streets Reimagined for People, Businesses and Community

Convenient Town Centre Parking

Nature Linking Sea and Town Centre

Leisure, Spa and Training

Sense of Arrival. New Grand Stair. Heritage Restored



Museum and Library on Prominent Waterfront Site

Live Work Units Overlooking Marina

Kilometre Long Promenade

Coffee Outlet at Weighbridge

New Craft Industry within Front Portion of Auction Hall

Ice Plant Transformed into Cultural Venue



Library & Museum



Marina View Live-Work

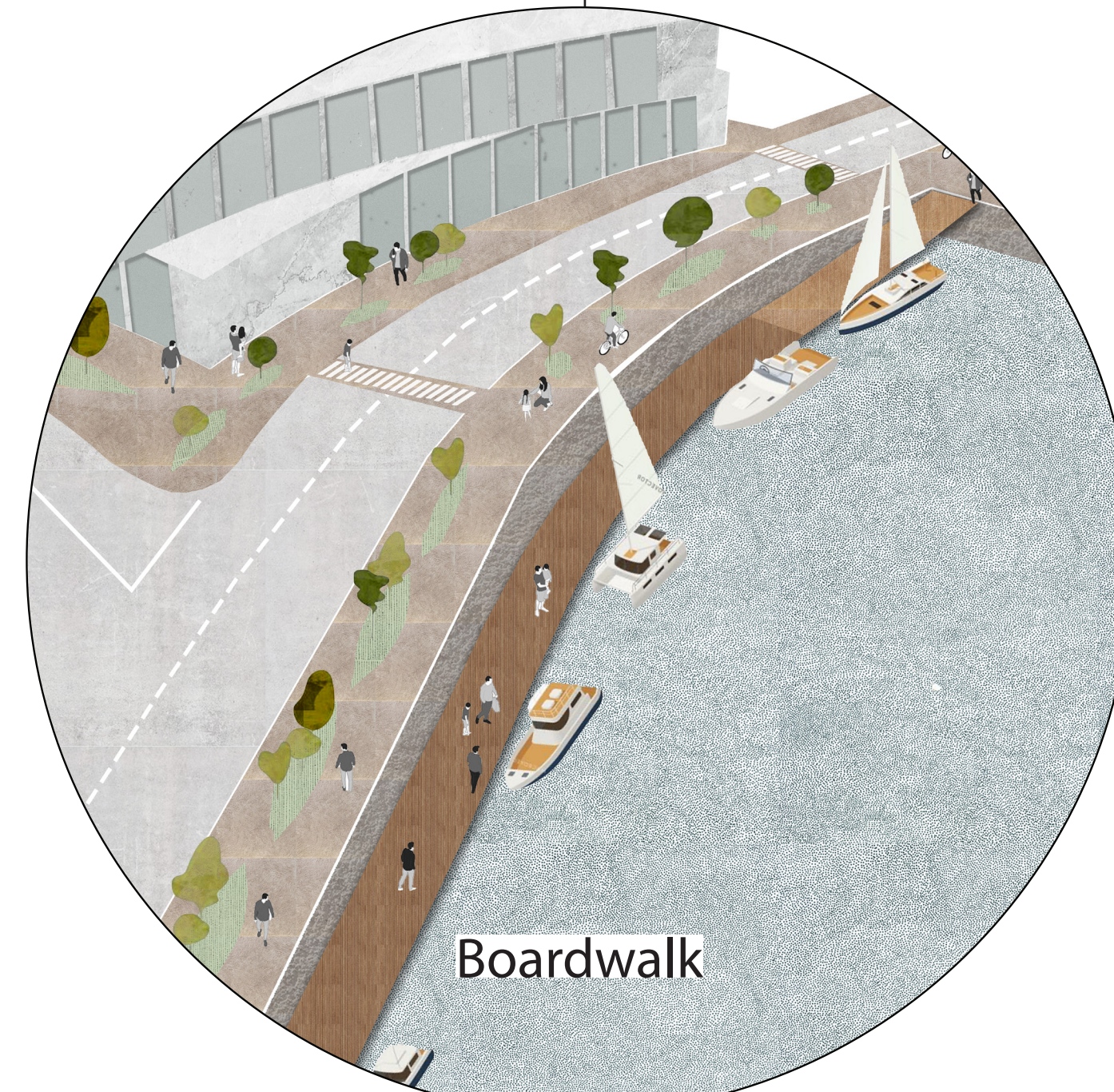

Boardwalk



Weighbridge Coffee House



Pelagic Beer Brewery

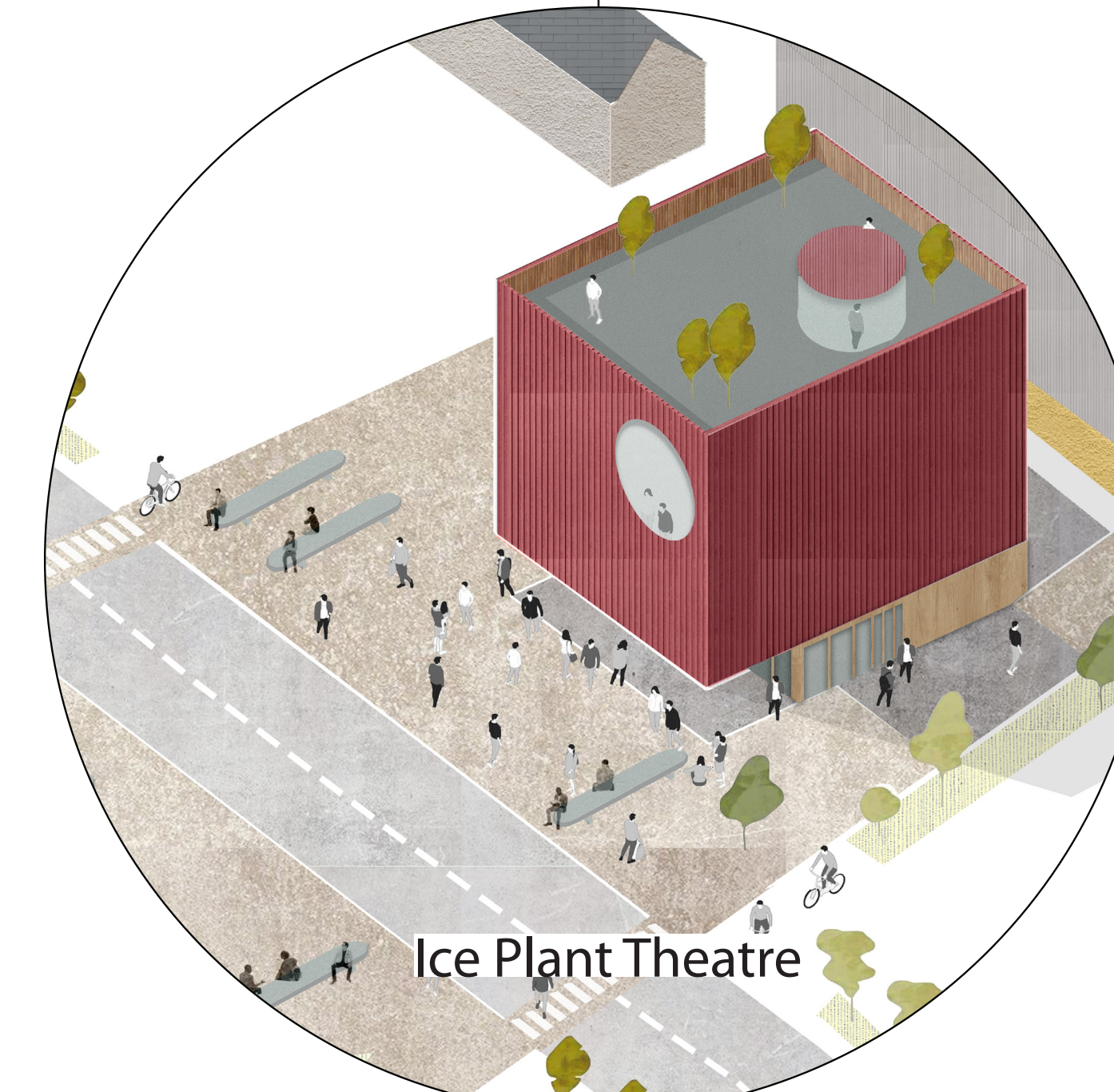

Ice Plant Theatre